

“AUTO-SPRAY” NOZZLES SUBMITTAL SHEET

WIDE ANGLE “AUTO-SPRAY” NOZZLE - TYPE WA - 120° PATTERN

Medium Angle type “AUTO-SPRAY” NOZZLES produce a conical pattern 120° in diameter and are available in FOUR orifice sizes. These nozzles are available for 1” and 1-1/4” pipe connections.

Nozzle No.	Pipe Conn. (Male)	Orifice K Factor	Flow Rate in gpm for given psi										
			10	15	20	30	40	50	60	70	80	90	100
10 WA	1”	1.8	5.7	7.0	8.0	9.9	11.4	12.7	13.9	15.1	16.1	17.1	18.0
14 WA	1”	2.6	8.2	10.1	11.6	14.2	16.4	18.4	20.1	21.8	23.3	24.7	26.0
18 WA	1-1/4”	3.3	10.4	12.8	14.8	18.1	20.9	23.3	25.6	27.6	29.5	31.3	33.0
29 WA	1-1/4”	5.3	16.8	20.5	23.7	29.0	33.5	37.5	41.1	44.3	47.4	50.3	53.0

WIDE ANGLE NOZZLE

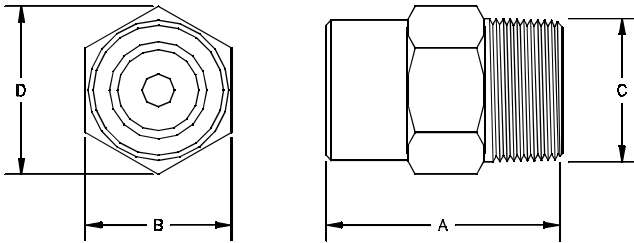

DISCHARGE CHARACTERISTIC

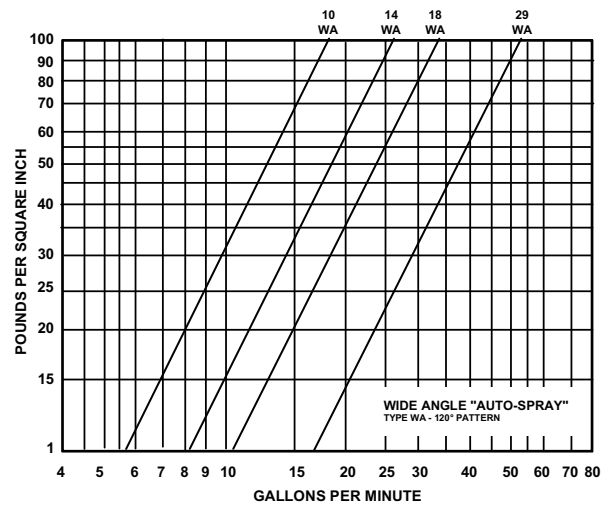

PHYSICAL CHARACTERISTICS				
Nozzle No.	Dimensions			
	A	B	C	D
10 WA	2-3/16	1-5/16	1	1-17/32
14 WA	2-3/16	1-5/16	1	1-17/32
18 WA	2-5/8	1-11/16	1-1/4	1-15/16
29 WA	2-5/8	1-11/16	1-1/4	1-15/16

ORDERING INFORMATION

Nozzle Number	Type	Pipe Conn. Male	Angle of Pattern	Inventory Code No.	Order (Check One)
10 WA	Wide Angle	1	120°	1415063	
14 WA	Wide Angle	1	120°	1415064	
18 WA	Wide Angle	1-1/4	120°	1415069	
28 WA	Wide Angle	1-1/4	120°	1415070	

This information is only a general guideline. The company reserves the right to change any portion of this information without notice. Terms and conditions of sale apply and are available on request.

12/00 Printed in USA SPS400Q