

“AUTO-SPRAY” NOZZLES SUBMITTAL SHEET

NARROW ANGLE “AUTO-SPRAY” NOZZLE - TYPE NA - 60° PATTERN

Narrow Angle type “AUTO-SPRAY” NOZZLES produce a conical pattern 60° in diameter and are available in six orifice sizes. These nozzles are available for 3/4” pipe connections.

Nozzle No.	Pipe Conn. (Male)	Orifice K Factor	Flow Rate in gpm for given psi										
			10	15	20	30	40	50	60	70	80	89	100
5 NA	3/4"	.9	2.8	3.5	4.0	4.9	5.7	6.4	7.0	7.5	8.0	8.5	9.0
7 NA	3/4"	1.2	3.8	4.6	5.4	6.6	7.6	8.5	9.3	10.0	10.7	11.4	12.0
8 NA	3/4"	1.4	4.4	5.4	6.3	7.7	8.9	9.9	10.8	11.7	12.5	13.3	14.0
10 NA	3/4"	1.8	5.7	7.0	8.0	9.9	11.4	12.7	13.9	15.1	16.1	17.1	18.0
12 NA	3/4"	2.2	7.0	8.5	9.8	12.0	13.9	15.6	17.0	18.4	19.7	20.9	22.0
14 NA	3/4"	2.6	8.2	10.1	11.6	14.2	16.4	18.4	20.1	21.8	23.3	24.7	26.0

Narrow Angle “AUTO-SPRAY” Nozzle

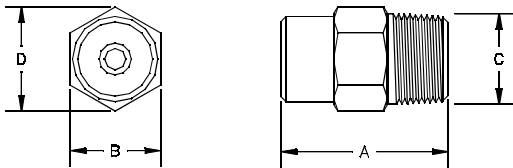

Nozzle No.	Physical Characteristics			
	Dimensions			
	A	B	C	D
5 NA	1 7/8	1 1/16	3/4	1 7/32
7 NA	1 7/8	1 1/16	3/4	1 7/32
8 NA	1 7/8	1 1/16	3/4	1 7/32
10 NA	1 7/8	1 1/16	3/4	1 7/32
12 NA	1 7/8	1 1/16	3/4	1 7/32
14 NA	1 7/8	1 1/16	3/4	1 7/32

Discharge Characteristics

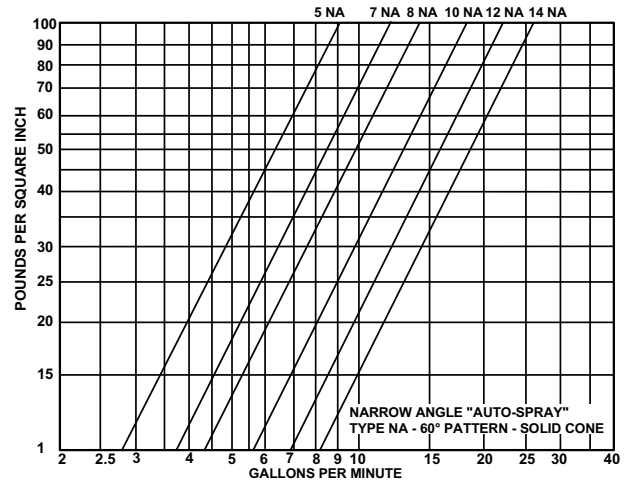

ORDERING INFORMATION:

Nozzle Number	Type	Pipe Conn. Male	Angle of Pattern	Inventory Code No.	Order (Check One)
5 NA	Narrow Angle	3/4	60°	1415050	
7 NA	Narrow Angle	3/4	60°	1415051	
8 NA	Narrow Angle	3/4	60°	1415052	
10 NA	Narrow Angle	3/4	60°	1415053	
12 NA	Narrow Angle	3/4	60°	1415054	
14 NA	Narrow Angle	3/4	60°	1415055	

This information is only a general guideline. The company reserves the right to change any portion of this information without notice. Terms and conditions of sale apply and are available on request.

12/00 Printed in USA SPS400Q